

Memorex[®]

16 CHANNEL RADIO SYSTEM

MODEL: MXT5000UP/MXT5000HP

**BEFORE OPERATING THIS PRODUCT,
PLEASE READ THESE INSTRUCTIONS COMPLETELY.**

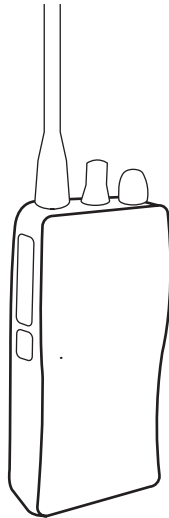

OPERATING INSTRUCTIONS

SAFETY PRECAUTIONS

FCC WARNINGS:

This device complies with part 15 of the FCC rules. Operation is subject to the condition that this device does not cause harmful interference.

PRECAUTIONS:

- Do not modify or attempt to adjust the transceiver for any reason.
- Avoid extremes in exposure to heat and cold.
- This unit is splash resistant to water. Do not submerge in water.
- Do not expose the transceiver to long periods of direct sunlight, nor should the transceiver be placed close to heating appliances.
- Do not place the transceiver in excessively dusty areas, humid areas, wet areas, or on unstable surfaces.
- Do not transmit for more than 50% of total radio use time (50% duty cycle). Transmitting more than 50% of the time can cause FCC RF exposure compliance requirements to be exceeded.
- This unit is NOT approved for use by the general population in an uncontrolled environment. This radio is restricted to occupational use, work related operations only where radio operator must have the knowledge to control its RF exposure conditions.
- Failure to observe these restrictions will result in exceeding the FCC RF exposure limits.
- Always use Memorex authorized accessories (antenna, batteries, belt clip, speaker mic, etc.).

IMPORTANT:

PLEASE KEEP ALL PACKAGING MATERIAL FOR AT LEAST 90 DAYS IN CASE YOU NEED TO RETURN THIS PRODUCT TO YOUR PLACE OF PURCHASE OR MEMOREX.

Before using, fill out and mail the registration card. This will make sure a permanent record is made with the date of purchase in case service is needed.

SAFETY PRECAUTIONS (CONTINUED)

SAFETY INFORMATION:

- Do NOT hold the unit in such a manner that the antenna is next to, or touching exposed parts of the body - especially the face or eyes, while transmitting.
- Do NOT allow children to operate transmitter-equipped radio equipment.
- Do NOT operate the unit near unshielded electrical blasting caps or in an explosive atmosphere, unless it is especially designed and qualified for such use.
- Do NOT press and hold the PTT button when not actually transmitting.
- Do NOT tamper with the internal radio adjustments. Damage to the equipment and/or improper operation may result. There are no user-serviceable parts inside. It is recommended that you return the unit to a qualified Memorex radio communications dealer for any service or parts.
- Do NOT carry the unit by the antenna.

MAINTENANCE:

This unit is designed to be maintenance free, but can be kept in good working condition by following these few recommendations:

- Clean all external surfaces with a clean cloth, dampened in a mild solution of dishwasher detergent diluted in water. Apply the solution sparingly to avoid any moisture leaking into the cracks. Dry the surface thoroughly with a soft, lint-free cloth.
- Do NOT use solvents or spirits for cleaning, they may permanently damage the unit.
- Clean the battery jack contacts with a lint-free cloth to remove dirt.

LOCATION OF CONTROLS

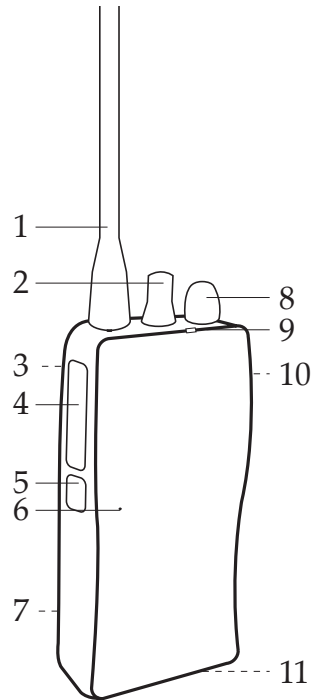

- | | |
|--------------------------------------|--|
| 1. Antenna | 8. Volume Control |
| 2. Channel Control | 9. LED Indicator |
| 3. Belt Clip (Rear of Unit) | 10. Microphone/Speaker Jack
(Side of Unit) |
| 4. PTT (Push To Talk) Button | 11. Battery Release Switch
(Bottom of Unit) |
| 5. Monitor Button | |
| 6. Microphone | |
| 7. Charge Contacts (Rear of
Unit) | |

INSTALLATION

UNPACKING THE UNIT:

Make sure the following items are included with your new unit:

- Radio Unit
- Antenna
- NiMH Battery Pack
- Belt Clip
- Owner's Manual

TO INSTALL THE ANTENNA

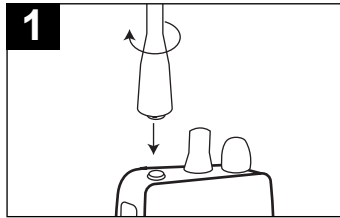

Simply screw the antenna into the connector on the top of the unit by holding the antenna at its base and turning it clockwise. Do not over-tighten.

TO INSTALL THE BELT CLIP

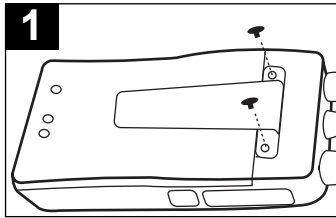

The belt clip will keep the unit from coming in contact with hot surfaces, and keep it away from your body heat. Using the two supplied screws, install the belt clip.

TO REMOVE/INSERT THE BATTERY PACK

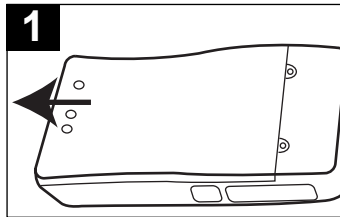

To remove the NiMH battery pack, simply push down the Battery Release switch and slide it in the direction of the arrow.

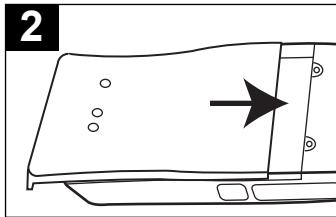

To insert the NiMH battery pack, place the battery on the compartment as shown above and slide it in the direction of the arrow.

TO CHARGE THE NiMH BATTERY PACK:

A charger (available separately) must be used to charge the NiMH battery pack prior to use. Install as follows:

1. Plug the charger's AC Adapter into the charger's AC jack located on the rear of the charger, then into an AC outlet.
2. Slide the NiMH battery pack into the charging slot.
3. Ensure the metal contacts on the NiMH battery pack come in contact with the charging terminals.
4. The charger LED will light to indicate that charging has begun. Charge the standard battery pack for approximately one hour. After the one hour, REMOVE THE NiMH BATTERY PACK FROM THE CHARGER.

NOTES:

- When the NiMH battery pack voltage is too low, the LED indicator will blink.
- Never dispose of the NiMH battery in a fire, it can explode and cause injury. Contact your local disposal waste center for instructions on disposal.
- Never attempt to disassemble the battery or remove its case or charging contacts. Do not short the battery terminals.

FOR BEST RESULTS WHEN CHARGING:

- Make sure the ambient temperature is between 41° and 104°F while charging. Temperatures outside of this range may not fully charge the battery.
- Always make sure the unit is off before charging.
- Do not recharge the NiMH battery pack if it is fully charged. Doing so may reduce the life or damage the NiMH battery pack.
- If the NiMH battery pack is stored for two months or more, it is a good idea to complete the charge/discharge cycle (explained on the next page) to allow the battery capacity to return to normal.
- After recharging the NiMH battery pack, remove it from the charger. Charging the NiMH battery pack for more than a few days will reduce the batteries life.
- The NiMH battery pack's charging capacity will decrease over

time, even with proper charging/discharging. Replace with the manufacturer's recommended model.

- Average NiMH battery pack charge capacity is 8+ hours. This time is approximate and is calculated using 90% standby, 5% transmit and 5% receive times.

CHARGE/DISCHARGE CYCLE:

The first few uses from the NiMH battery pack will not be at normal capacity. Completely charge, then allow it to completely discharge a few times to ensure the maximum charge capacity.

TO USE THE MICROPHONE/SPEAKER JACK:

A microphone/speaker cable (available separately) can be connected to this unit as follows:

1. Remove the Microphone/Speaker cover, located on the right side of the unit.
2. Plug a Microphone/Speaker cable into the Microphone/Speaker jacks.

NOTE: This automatically disconnects the internal speaker. Adjust to a desired volume level, but do not adjust the volume too high to avoid damage to your hearing.

OPERATIONAL NOTES:

- This unit is transmitting when the red LED indicator is lit (when the PTT button is pressed).
- When transmitting, hold the unit in a vertical position with the microphone one to two inches (2.5 to 5 cm) away from your mouth. Keep the antenna at least one inch (2.5cm) from your head and body.
- There are channels/features that the dealer will set for you using software provided by Memorex, such as CTCSS/DCS Tone Signalling, Scanning, Busy Channel Lockout, Marked Idle, Time-Out Timer/Penalty, Two-Tone Decode and Cloning. This manual does not cover these additional features, so please get this information from the dealer.

OPERATION

TO TURN THE UNIT ON/OFF

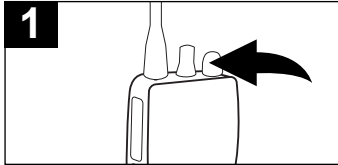

1
Rotate the Volume control clockwise until a click is heard to turn the unit on; a confirmation tone will sound. Rotate the Volume control counterclockwise until a click is heard to turn the unit off.

TO ADJUST THE VOLUME

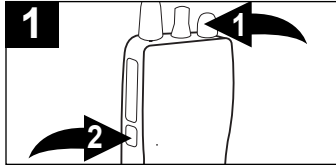

1
Rotate the Volume control 1 clockwise to adjust the volume. If necessary, press and hold the Monitor button 2 when adjusting so sound will be heard through the speaker.

TO SELECT A CHANNEL

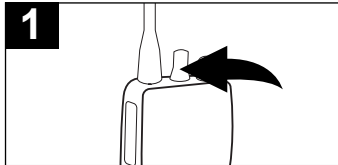

1
To select a channel, simply rotate the Channel control on the top of the unit.
Note that channels can be preset by the dealer. The dealer will have given you full instructions on what channels have been set.

TO TRANSMIT

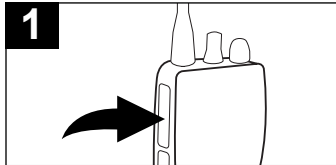

1
To transmit, press and hold the PTT button and speak into the built-in microphone (or the external microphone, if connected). When the PTT button is pressed, the LED indicator will light red and the speaker will be muted. When the PTT button is released, you can now listen to incoming messages.

OPERATION (CONTINUED)

LISTENING TO TRANSMISSIONS AUTO SQUELCH

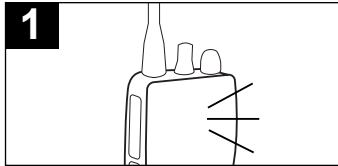

When the unit is on, it will automatically broadcast the incoming signal when a strong incoming signal is received on the selected channel.

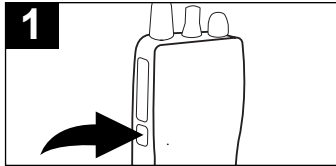

This unit is equipped with Auto Squelch, which will automatically mute weak transmissions and unwanted noise. Auto Squelch can be temporarily turned off using the Monitor button.

RANGE:

This unit has an approximate range of between two and three miles. The range is dependent on the terrain, buildings, steel/concrete, etc. General rules for a longer range is being at a high elevation, having minimal obstructions in your way, and a line of sight communication.

BATTERY SAVE:

When a signal is not received and no operations are being performed (no buttons pressed, etc.), the battery save function will decrease the amount of power used.

FCC LICENSING:

The Federal Communications Commission requires the operator of this unit to be properly licensed under the applicable Part and/or Parts of the FCC Rules and Regulations. Consult your Memorex radio communications dealer, or contact the nearest FCC Field Office for information about a license.

SPECIFICATIONS

Jim, Please advise if you would like specifications included with this manual. If yes, please advise them.

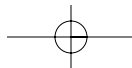
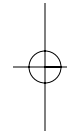
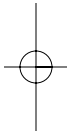

FOR ADDITIONAL SET-UP OR OPERATING ASSISTANCE,
PLEASE VISIT OUR WEBSITE AT

WWW.MEMCORPINC.COM

OR CONTACT CUSTOMER SERVICE AT 1-800-919-3647

PLEASE KEEP ALL PACKAGING MATERIAL FOR AT
LEAST 90 DAYS IN CASE YOU NEED TO RETURN THIS
PRODUCT TO YOUR PLACE OF PURCHASE OR
MEMOREX.

FOR PARTS AND ACCESSORIES, CONTACT FOX INT'L
AT 1-800-321-6993.

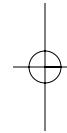
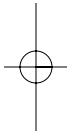

Memcorp, Inc.
Weston, FL
Printed in Hong Kong

Visit our website at www.memcorpinc.com

